



ANATECH ELECTRONICS INC
RF & Microwave Filters & Products

8770 MHz Cavity Bandpass Filter

Part Number: AE8770B8641



Electrical Specifications

Center Frequency: 8770 MHz
0.5-dB Bandwidth: 4000 MHz
Passband: 7000 MHz to 11000 MHz
Impedance: 50 Ohms
Insertion Loss: ≤ 1.2 dB
VSWR: $< 1.5:1$
Rejection 1 : ≥ 30 dB @ 2500 MHz
Rejection2 : ≥ 60 dB @ 5000 MHz
Rejection3 : ≥ 20 dB @ 12000 MHz
Rejection4 : ≥ 30 dB @ 14000 MHz
Rejection5 : ≥ 60 dB @ 16000 MHz
Rejection6 : ≥ 30 dB @ 17000 MHz to 21000 MHz

Mechanical

Mounting Method: Drop-in Through Holes
Dimensions: 1.65" X 0.75" x 0.5" in.

Environmental

Operating Temperature: -40°C to $+70^{\circ}\text{C}$
Storage Temperature: -25°C to $+90^{\circ}\text{C}$
Shock: 20 G. 11ms
Vibration: 20 G. 5 to 200Hz

Outline Drawing:

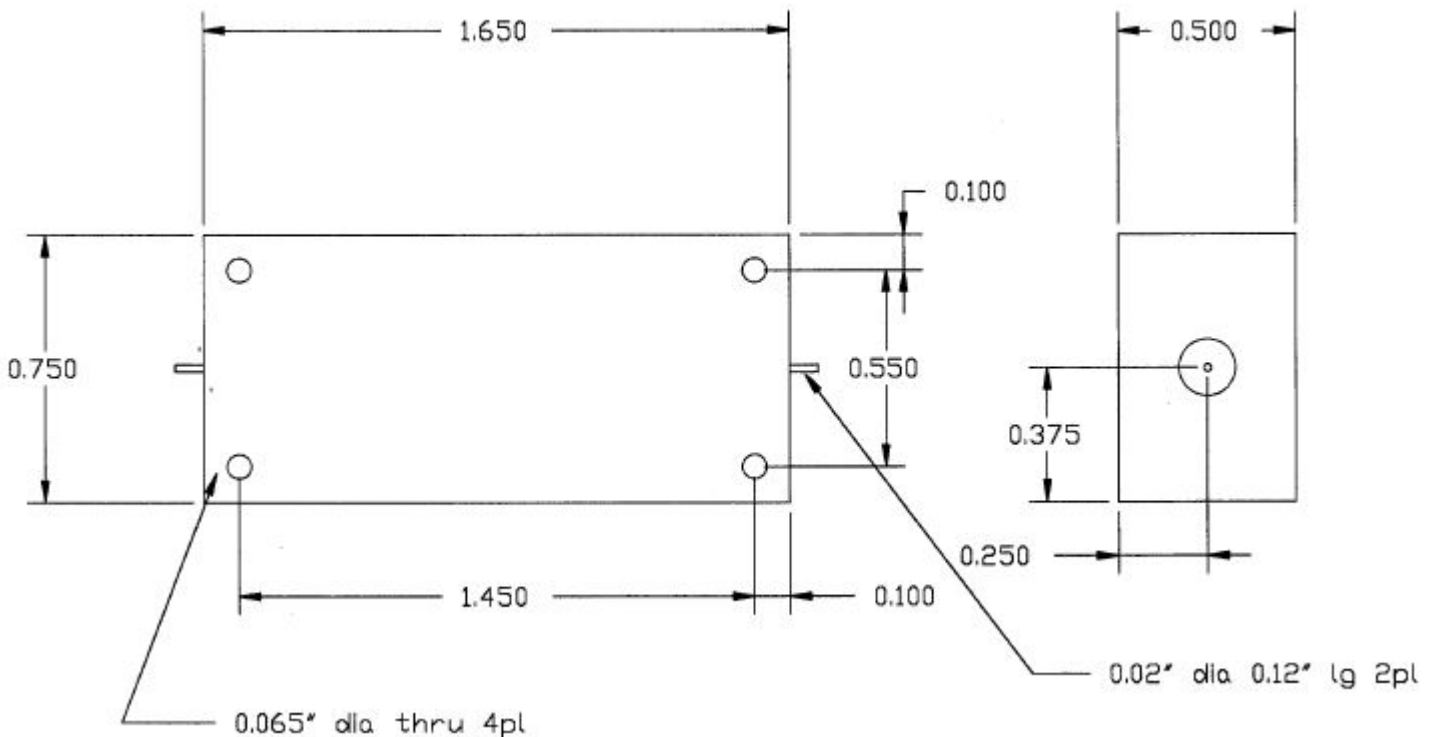



ANATECH ELECTRONICS INC
RF & Microwave Filters & Products

8770 MHz Cavity Bandpass Filter

Part Number: AE8770B8641



Response Plot:

ANATECH ELECTRONICS 7-11GHz BPF P/N B8641

JAN 14, 2004

Attenuation/Return Loss

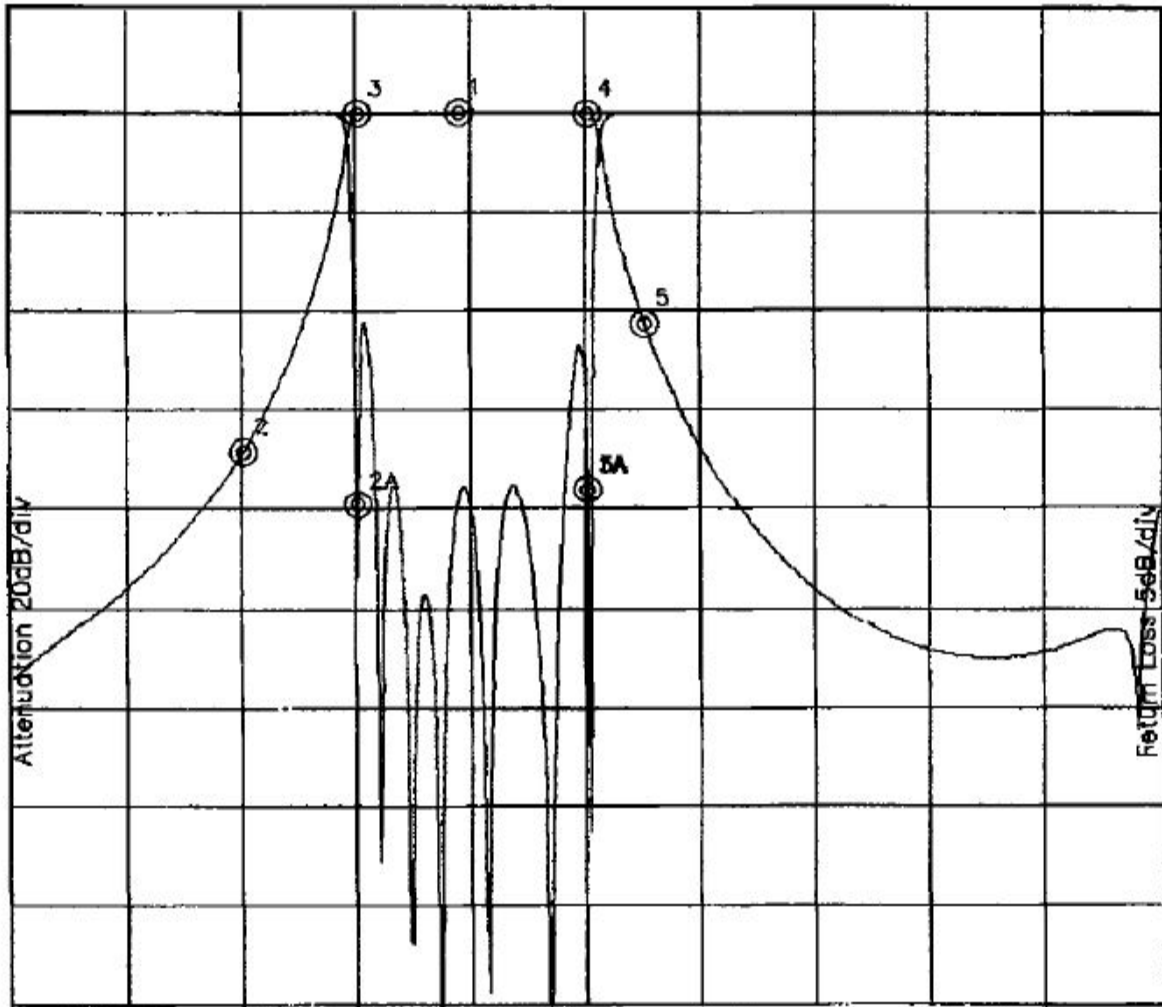

Attenuation Start: 1000.0MHz Stop: 21.0GHz

Return Loss Start: 1000.0MHz Stop: 21.0GHz

Marker 1 Freq 8.787GHz Atten -0.158dB
Marker 2 Freq 5.006GHz Atten -08.785dB
Marker 3 Freq 7.010GHz Atten -0.258dB
Marker 4 Freq 11.016GHz Atten -0.308dB
Marker 5 Freq 12.018GHz Atten -43.126dB

Marker 1A Freq 11.016GHz Ret Loss -19.124dB
Marker 2A Freq 7.010GHz Ret Loss -19.941dB
Marker 3A Freq 11.016GHz Ret Loss -19.124dB